



# HIGH OUTPUT FLUORESCENT LAMP HOLDERS R17d BASE DOUBLE RECESSED CONTACTS

HO  
Fluorescent

1

**FLSA-12PG-PI** HO Lampholder for 800 and 1500mA lamps  
Fixed end, push-in terminals

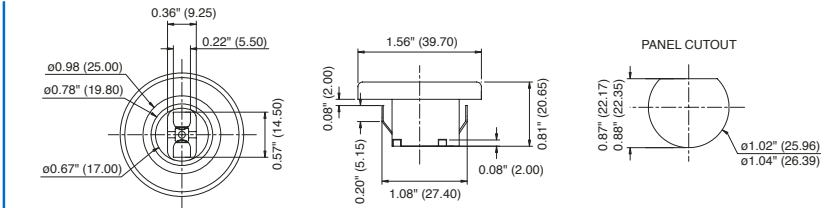
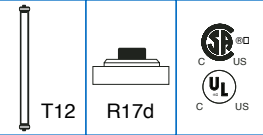

- Body made from PC material
- Silver plated Phosphor Bronze contacts
- Stationary end of set, both are required
- Push-in terminals for solid ballast wires direct into the lampholder, no extra connections

- Neoprene "O" ring gasket
- Snap in mount into panel
- Recommended panel thickness .0312" to .0625"

- Rated 600V 660W or 1000V 660W for non-home use
- Certified for outdoor use in enclosed fixtures
- $cCSA_{US}$  and  $cUL_{US}$  listed

**FLSA-12PG-L** HO Lampholder for 800 and 1500mA lamps  
Fixed end, wire leads

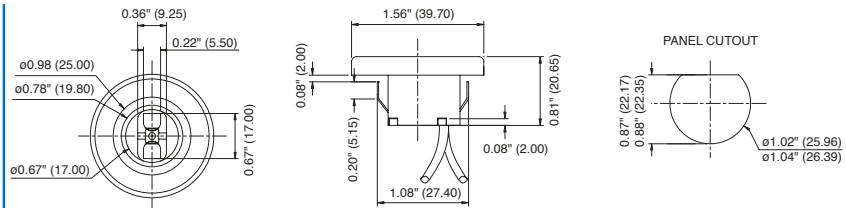
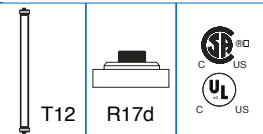

- Body made from PC material
- Silver plated Phosphor Bronze contacts
- Stationary end of set, both are required
- 9" 18AWG TEW AWN 105°C wire leads, stripped 1/2" or per customer specifications

- Neoprene "O" ring gasket
- Snap in mount into panel
- Recommended panel thickness .0312" to .0625"

- Rated 600V 660W or 1000V 660W for non-home use
- Certified for outdoor use in enclosed fixtures
- $cCSA_{US}$  and  $cUL_{US}$  listed

**FLSE-12PG-PI** HO Lampholder for 800 and 1500mA lamps  
Spring end, push-in terminals

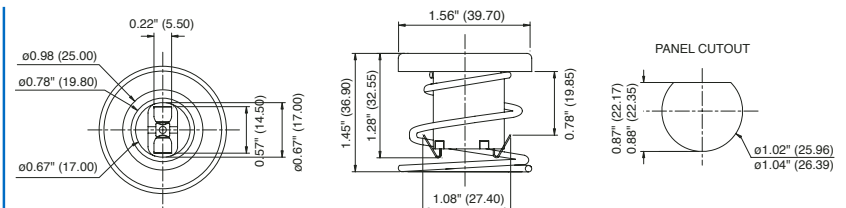
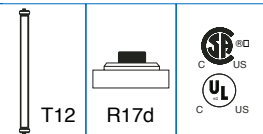

- Body made from PC material
- Silver plated Phosphor Bronze contacts
- Spring end of set, both are required
- Push-in terminals for solid ballast wires direct into the lampholder, no extra connections

- Neoprene "O" ring gasket
- Snap in mount into panel
- Recommended panel thickness .0312" to .0625"

- Rated 600V 660W or 1000V 660W for non-home use
- Certified for outdoor use in enclosed fixtures
- $cCSA_{US}$  and  $cUL_{US}$  listed

Continued on the next page...

## HIGH OUTPUT FLUORESCENT LAMPHOLDERS R17d BASE DOUBLE RECESSED CONTACTS



2

FLSE-12PG-L

HO Lampholder for 800 and 1500mA lamps  
Spring end, wire leads

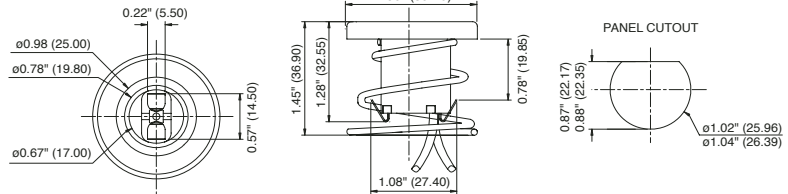
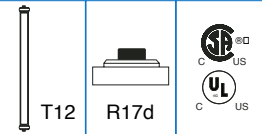

- Body made from PC material
- Silver plated Phosphor Bronze contacts
- Spring end of set, both are required
- 9" 18AWG TEW AWN 105°C wire leads, stripped 1/2" or per customer specifications

- Neoprene "O" ring gasket
- Snap in mount into panel

- Rated 600V 660W or 1000V 660W for non-home use
- Certified for outdoor use in enclosed fixtures
- $cCSA_{US}$  and  $cUL_{US}$  listed

FL540-W

HO Lampholder for 800 and 1500mA lamps  
Butt on, plunger end, wire leads

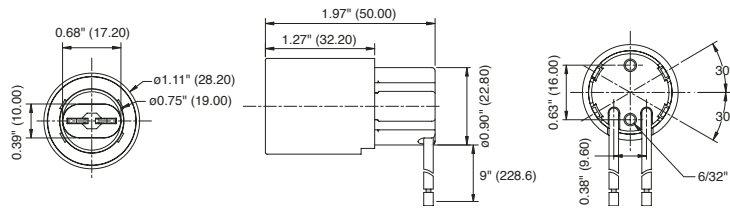
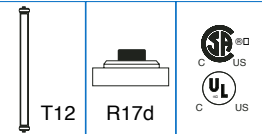

- Body made from PC material
- Silver plated Phosphor Bronze contacts
- Plunger end of set, both are required
- 9" 18AWG TEW AWN 105°C wire leads, stripped 1/2" or per customer specifications

- Neoprene "O" ring gasket
- Mounts using (2) 6/32" screws into socket

- Rated 600V 660W or 1000V 660W for non-home use
- Certified for outdoor use in enclosed fixtures
- $cCSA_{US}$  and  $cUL_{US}$  listed

FL541-W

HO Lampholder for 800 and 1500mA lamps  
Fixed end, wire leads

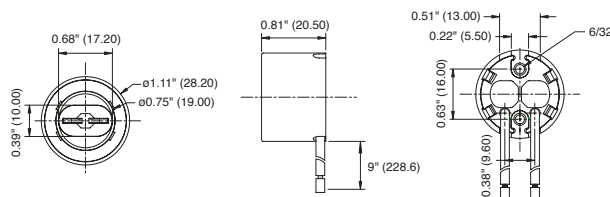
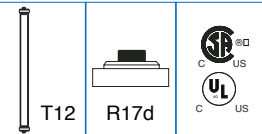

- Body made from PC material
- Silver plated Phosphor Bronze contacts
- Fixed end of set, both are required
- 9" 18AWG TEW AWN 105°C wire leads, stripped 1/2" or per customer specifications

- Neoprene "O" ring gasket
- Mounts using (2) 6/32" screws into socket

- Rated 600V 660W or 1000V 660W for non-home use
- Certified for outdoor use in enclosed fixtures
- $cCSA_{US}$  and  $cUL_{US}$  listed

Continued on the next page...



# HIGH OUTPUT FLUORESCENT LAMP HOLDERS R17d BASE DOUBLE RECESSED CONTACTS

HO  
Fluorescent

3

**FL630-L** HO Lampholder for 800 and 1500mA lamps  
Spring end, wire leads

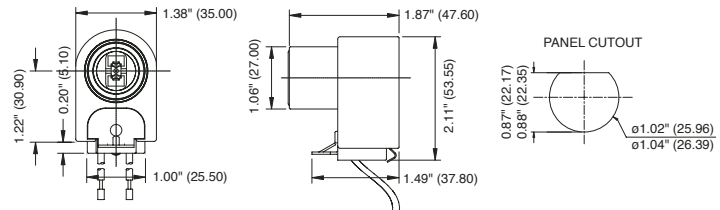
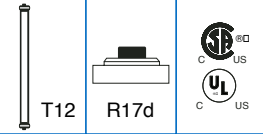

- Body made from PC material
- Silver plated Phosphor Bronze contacts
- Spring end of set, both are required
- 9" 18AWG TEW AWN 105°C wire leads, stripped 1/2" or per customer specifications

- Neoprene "O" ring gasket
- Mounts into "D" hole in panel
- For .036" to .048" panel thickness
- Available in vertical or horizontal contacts

- Rated 600V 660W or 1000V 660W for non-home use
- Certified for outdoor use in enclosed fixtures
- $cCSA_{US}$  and  $cUL_{US}$  listed

**FL631-L** HO Lampholder for 800 and 1500mA lamps  
Fixed end, wire leads

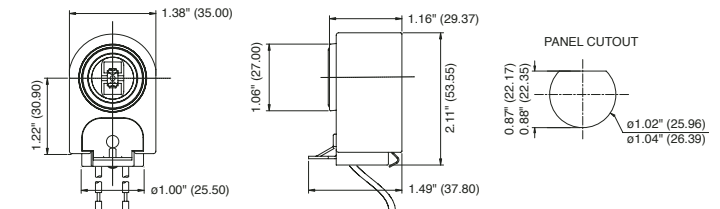
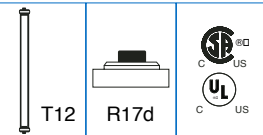

- Body made from PC material
- Silver plated Phosphor Bronze contacts
- Plunger end of set, both are required
- 9" 18AWG TEW AWN 105°C wire leads, stripped 1/2" or per customer specifications

- Neoprene "O" ring gasket
- Mounts into "D" hole in panel
- For .036" to .048" panel thickness
- Available in vertical or horizontal contacts

- Rated 600V 660W or 1000V 660W for non-home use
- Certified for outdoor use in enclosed fixtures
- $cCSA_{US}$  and  $cUL_{US}$  listed

**FL630-PI** HO Lampholder for 800 and 1500mA lamps  
Spring end, push-in terminals

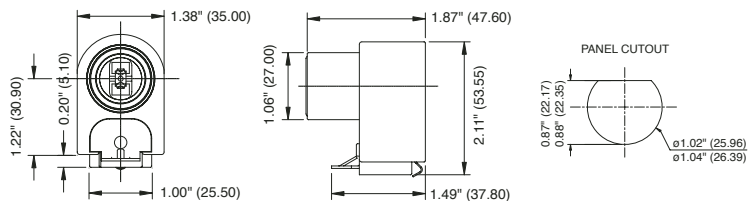
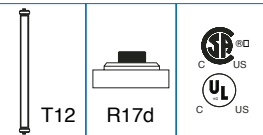

- Body made from PC material
- Silver plated Phosphor Bronze contacts
- Spring end of set, both are required
- Push-in terminals for solid ballast wires direct into the lampholder, no extra connections

- Neoprene "O" ring gasket
- Mounts into "D" hole in panel
- For .036" to .048" panel thickness
- Available in vertical or horizontal contacts

- Rated 600V 660W or 1000V 660W for non-home use
- Certified for outdoor use in enclosed fixtures
- $cCSA_{US}$  and  $cUL_{US}$  listed

Continued on the next page...

## HIGH OUTPUT FLUORESCENT / COMPACT FLUORESCENT LAMPHOLDERS



4

**FL631-PI** HO Lampholder for 800 and 1500mA lamps  
Fixed end, push-in terminals

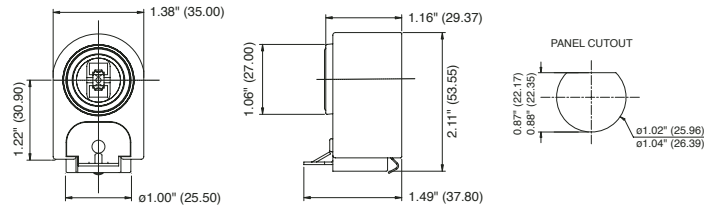
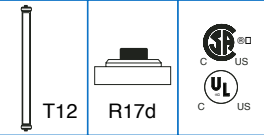

- Body made from PC material
- Silver plated Phosphor Bronze contacts
- Fixed end of set, both are required
- Push-in terminals for solid ballast wires direct into the lampholder, no extra connections
- Neoprene "O" ring gasket
- Mounts into "D" hole in panel
- For .036" to .048" panel thickness
- Available in vertical or horizontal
- Rated 600V 660W or 1000V 660W for non-home use
- Certified for outdoor use in enclosed fixtures
- $c_{CSA}_{US}$  and  $c_{UL}_{US}$  listed

**CF2G7-HSM** 2G7 5/7/9W Horizontal Screw Mount  
**CF2GX7-HSM** 2GX7 13W Horizontal Screw Mount

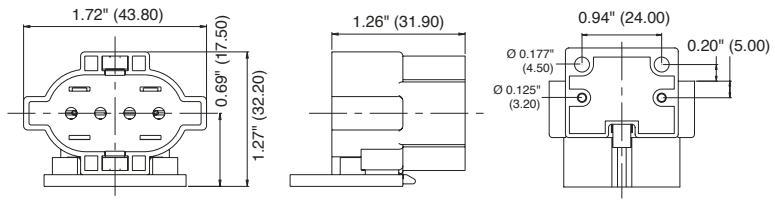
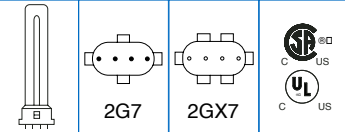

- Made from polycarbonate rated 125°C
- Phosphor Bronze contacts
- Screw mounts into panel horizontally
- Can be mounted horizontally, using screws into the socket using thread cutting screws
- Quick connect push-in wire terminals for 18 AWG solid or bonded Copper wire, stripped 7/16"
- Screw mounts into (2) .177" holes in panel
- Cutting screws go into (2) .125" holes in socket
- Two wire ports per terminal
- Rated 75W 600V
- $c_{CSA}_{US}$  approved and  $c_{UL}_{US}$  listed

**CF2G7-VHSM** 2G7 5/7/9W Vertical Horizontal Screw Mount  
**CF2GX7-VHSM** 2GX7 13W Vertical Horizontal Screw Mount

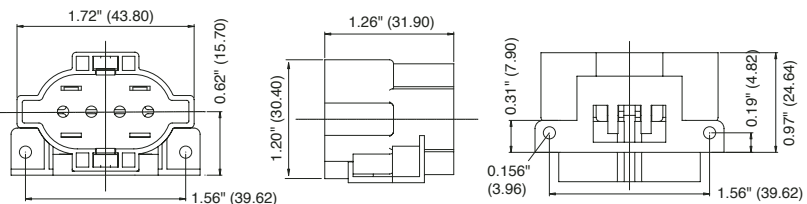
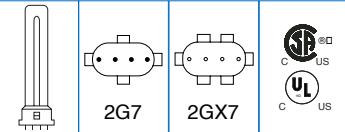

- Made from polycarbonate rated 125°C
- Phosphor Bronze contacts
- Can be mounted either vertically or horizontally on the panel
- Quick connect push-in wire terminals for 18 AWG solid or bonded Copper wire, stripped 7/16"
- Screw mounts into (2) .156" holes in panel
- Two wire ports per terminal
- Rated 75W 600V
- $c_{CSA}_{US}$  approved and  $c_{UL}_{US}$  listed

Continued on the next page...



# COMPACT FLUORESCENT LAMPHOLDERS 2G7, 2GX7 BASE

Compact  
Fluorescent

5

CF2G7-HSI  
CF2GX7-HSI

2G7 5/7/9W Horizontal Snap In Mount  
2GX7 13W Horizontal Snap In Mount

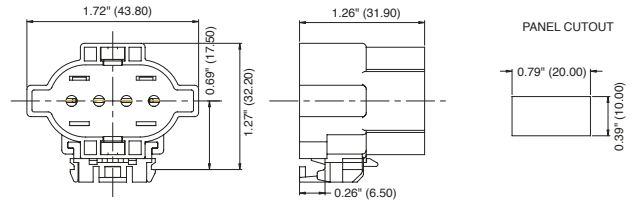
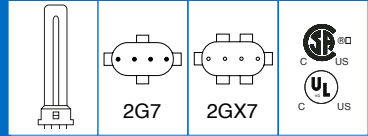

- Made from polycarbonate rated 125°C
- Phosphor Bronze contacts
- Snaps into panel for faster assembly time

- Quick connect push-in wire terminals for 18 AWG solid or bonded Copper wire, stripped 7/16"
- Fits into 20mm x 10mm panel cut out

- Two wire ports per terminal
- Rated 75W 600V
- cCSA<sub>US</sub> approved and cUL<sub>US</sub> listed